

Town of Alban Zoning

Portage County, Wisconsin

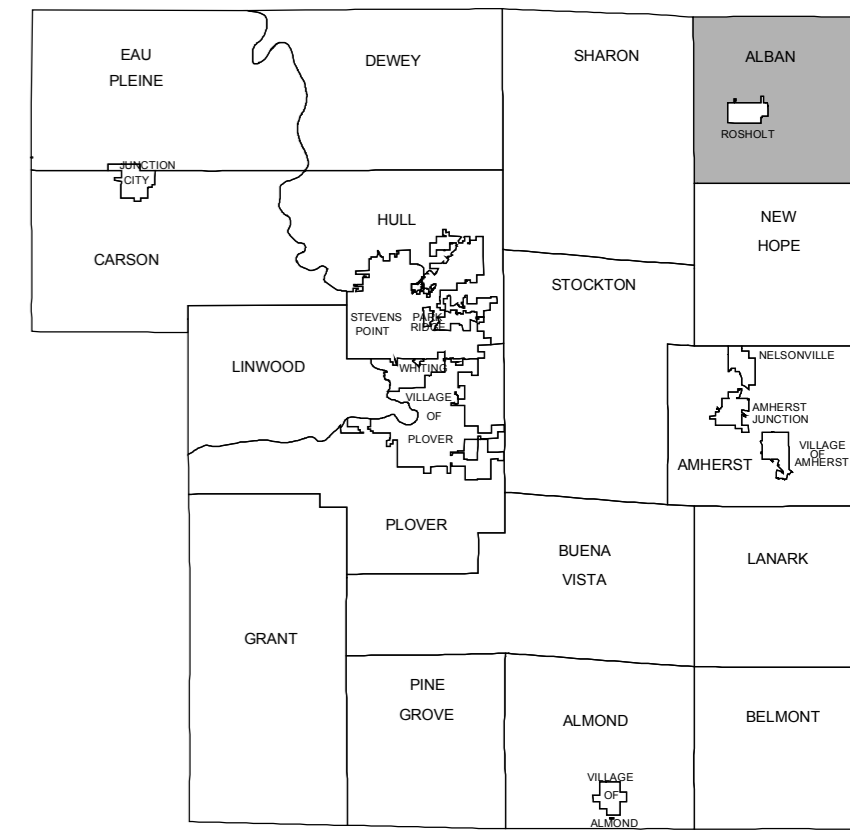

Portage County Zoning Districts

- R1 Rural and Urban Fringe Residence
- R2 Single Family Residence
- R3 One & Two Family Residence
- R4 Multiple Family Residence
- R5 Waterfront Residence
- CON Conservancy
- A1 Exclusive Agricultural
- A20 Primary Agriculture
- A2 Agricultural Transition
- A3 Low Density Agricultural
- A4 General Agricultural
- REC Recreational
- C1 Neighborhood Commercial
- C2 Marina
- C3 Commercial
- C4 Highway Commercial
- IND Industrial

- Interstate or U.S. Highway
- State Highway or County Road
- Local Road
- Private Road
- Section Lines
- Water Bodies (Conservancy unless otherwise noted)

Notes

Original Adoption: February 20, 1968

Map Updated: May 18, 2010

This zoning map is for illustrative purposes only.
For specific zoning questions, please consult
Portage County Planning and Zoning Staff.
Telephone: (715) 346-1334.



1 inch = 2,000 feet

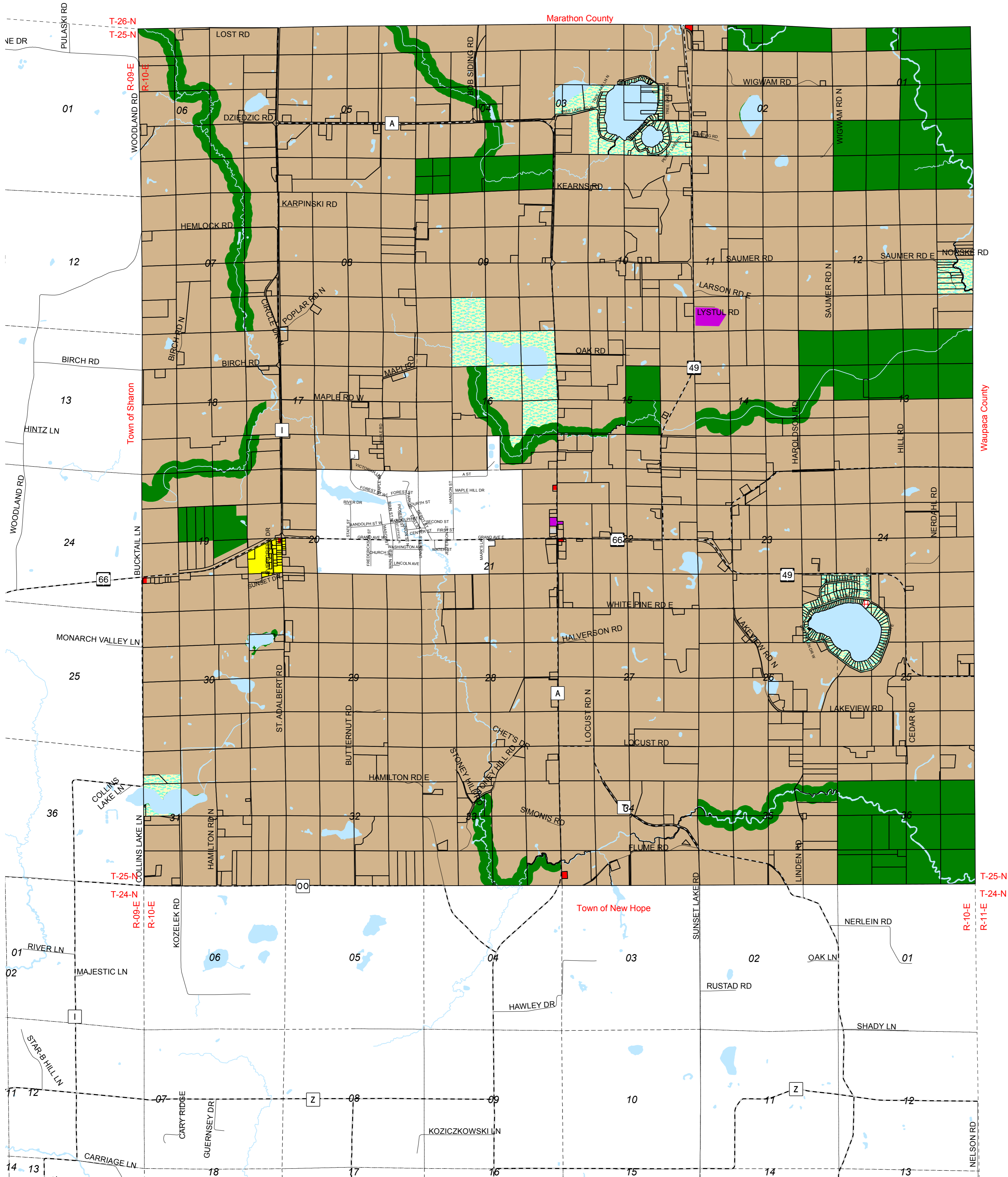
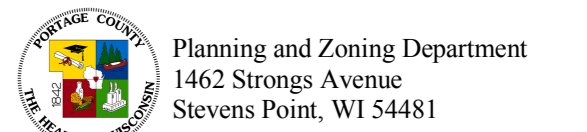

Marathon County

Waupaca County

Town of New Hope

T-26-N
T-25-N

R-10-E
R-09-E

Town of Sharon

T-25-N
T-24-N

R-09-E
R-10-E

T-25-N
T-24-N

R-10-E
R-11-E