

## Start a Recycling Program at your Business

### **Know the Players**

Identify all who will play a role. Contact your waste hauler. Explain recycling roles in contracts, job descriptions, rental agreements etc.

### **Know the Waste**

Find out what's in the trash and how much. Use purchasing and vendor plans and an actual look in the trash. Notice what is discarded and where.

### **Form a Plan of Action**

Recycle cans, bottles, cardboard and paper. Know what needs to be collected where.

### **Choose Bins**

Recycling bins should be easy to spot and look different from trash barrels. ALWAYS place a trash receptacle next to a recycling bin. Choose loading area containers to suit the space and budget.

### **Plan Operations**

Make recycling part of everyday maintenance. Train the crew and involve them in trouble-shooting.

### **Involve the Crowd**

Use strategic signs and a logical set-up to involve the public and prevent mistakes.

### **Pay Attention**

Be ready for on-the-spot trouble-shooting and long-range fine-tuning. Monitor, keep records and refine.

**Support Your County Programs  
because they support you!**

## Why Use County Services?

The County Solid Waste Department *does NOT* receive any county tax dollars. Funding sources are user or tipping fees, state grant funds and material revenues

### **Services Available to Your Business**

Waste Assessments  
Marketing Assistance  
Business Product Exchange  
Tips/Resources to save money by reducing waste  
Enforcement/Complaints

Revised 11/25/09

## On-line Business Recycling Resources

Wisconsin Department of Natural Resources  
[www.dnr.state.wi.us/org/aw/wm/publications/](http://www.dnr.state.wi.us/org/aw/wm/publications/)  
<http://dnr.wi.gov/org/aw/wm/markets/>

Wisconsin Focus on Energy  
[www.focusonenergy.com](http://www.focusonenergy.com)

WasteCap Wisconsin, Inc.  
[www.wastecapwi.org](http://www.wastecapwi.org)

Business for Social Responsibility  
[www.bsr.org](http://www.bsr.org)

GreenBiz  
[www.greenbiz.com](http://www.greenbiz.com)

Portage County

## Business Recycling & Solid Waste Solutions

### **Material Recovery Facility (MRF)**

600 Moore Road  
Plover, WI 54467  
Operations (715) 343-6297

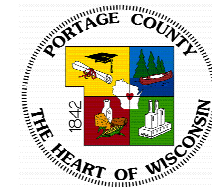

### **Solid Waste Transfer Facility**

650 Moore Road  
Plover, WI 54467  
Operations (715) 343-6297

### **Solid Waste/Recycling Information Line:**

**Recycling Connections Corporation**  
(715) 345-5972  
for recycling or other disposal options

## Why Should My Business Recycle?

Portage County's Solid Waste Ordinance, in accordance with WI Statute NR 544, **requires** businesses and institutions to separate the following items for recycling, **regardless of where the waste will be disposed!**

- Aluminum & glass containers
- Steel containers
- Plastic containers #1(PETE) & #2 (HDPE)
- Bi-metal containers (steel/aluminum)
- Corrugated paper
- Magazines, newspapers, office-paper non-residential) & similar papers (free confidential shredding)
- Waste Tires
- Lead acid batteries
- Yard materials
- Major appliances
- Used motor oil
- Fluorescent bulbs & computers

These items may also be recycled: hazardous materials, tires, antifreeze (limited quantities,) scrap metals, electronics and more.

### Portage County Solid Waste Department

600 Moore Road  
Plover, WI 54467

Phone: 715-345-5969

Fax: 715-345-5971

E-mail:

schedlers@portage.co.wi.us



## The Material Recovery Facility & the NEW Solid Waste Transfer Facility

### Location:

The Material Recovery Facility (MRF) & the NEW Solid Waste Transfer Facility (SWTF) are located about one mile east of I-39 and Cty. Hwy B (Exit 153) in the village of Plover. Turn north on Apache Drive. The NEW Solid Waste Transfer Facility is located on Moore Road west of the Material Recovery Facility.

### Hours:

Monday through Friday 7:30 a.m. to 3:30 p.m.\*  
Saturday 7:30 a.m. to 11:00 a.m.

\* **Please arrive 30 minutes prior to closing to allow enough time for unloading.**

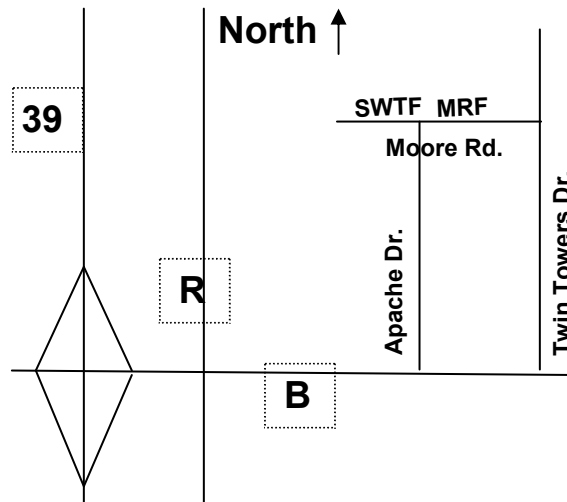

## Delivering Recyclables to the MRF:

**(No Fee)** The MRF only accepts Portage County materials delivered by municipalities, haulers, businesses, institutions and apartment complexes.

- Deliver materials loose (no plastic bags).
- **All loads must be covered or enclosed to prevent littering. Violators will be cited!**
- **All loads are weighed!** Upon arrival pull onto the drive-on scale, STOP, wait for green light to proceed.
- Inform attendant what business or institution you represent.
- Deliver materials & drive back on the scale then wait for the green light to proceed.

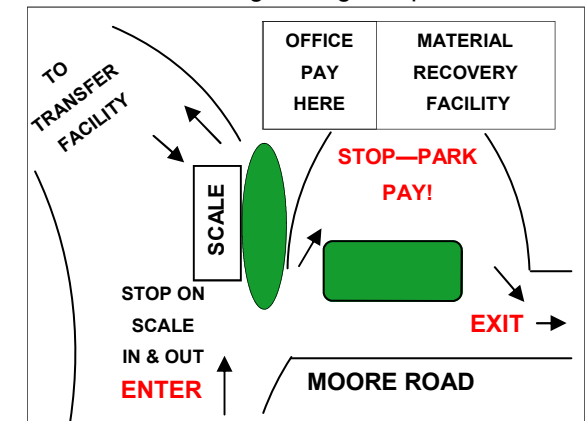

## Delivering to the Transfer Facility:

**(Call for pricing)** The Solid Waste Transfer Facility is open to the public and accepts these types of waste: Residential, Commercial, Construction/Demolition

- **All loads must be covered or enclosed!** Uncovered loads will be refused and drivers will be cited.
- **All loads are weighed** upon arrival and after unloading materials. Stop at the scale office after unloading for payment. Violators will be cited.
- Materials may be tipped onto the Transfer Facility's tipping floor. Ask attendant for more information on where to tip.

### Safety Rules:

Authorized personnel **ONLY** in active areas. No children under 16 allowed. No pets allowed.